



Move and Delivery Overview and Policies

This document includes key information regarding moving and deliveries at Aura. This is intended to be a helpful summary, but please remember that compliance with all HOA rules, regulations, and governing documents is required.

Site Logistics

- **Pre-Closing Deliveries.** Neither the contractor, developer, or HOA can accept or hold any deliveries for owners or designers prior to closing. All of your personal items should be delivered off-site in preparation for your move. In the interest of protecting your items, anything that is sent to the construction site will be returned to sender.
- **Ongoing Work.** At the time of your Closing, work in various areas of the garage, common areas, elevators and stair cores could still be on-going. Please be aware that all circulation through the garage and the building may initially be shared with contractors as well as other Owners and guests.
- **Moving Truck Staging.** While work is ongoing in the autocourt, all move and delivery trucks must be staged in the pull-off adjacent to Wood Road. When work is complete in the autocourt, a moving vehicle may also be staged in a designated space on the north side of the autocourt. Both of these areas are designated emergency vehicle zones per the Town of Snowmass Village. Vehicles may not be left unattended. The driver must remain with the truck in the event it needs to be moved.
- **Building Entrances.** There are two main points of entry to the main level from the exterior; one on each side of the building, and an exterior entry into the x01 stair core on the left side of the building. It is recommended that all movers route from the truck to the residence to understand the path of travel.
- **Elevator Access.** Aura residences feature direct elevator access. Only one of the three building elevators serves each particular residence. Each unit can also be accessed by two different stairwells.

Moving Logistics

- **Scheduling.** You will be able to schedule your move once your closing date has been confirmed. **All moving and furniture delivery activities must be scheduled with the HOA Manager through written confirmation at least three (3) business days in advance to ensure truck staging capacity and elevator availability.**
 - All moves must be confirmed in writing by the HOA Manager. Time slots will be filled on a first come first serve basis. To review availability and to schedule, please contact the HOA Manager, Rob Leisure: RLeisure@eastwest.com
- **Hours.** Moving activities may only occur during the hours of 7:00 a.m. until 6:00 p.m. unless otherwise approved by the HOA Manager.

This move and delivery information is provided as of September 2024 and subject to change as deemed necessary.

AURA

- **Loading Zone/Staging Area.** Movers may only utilize areas approved by the HOA Manager for loading and unloading activities. Pursuant to Snowmass Village regulations, the driver must stay with the truck during moving or delivery activities, so that the truck can be relocated if required. **No moving or delivery vehicles are allowed within the project's parking garage.**
- **No Obstructions.** Moves and deliveries cannot obstruct walkways, entrances, stairways, elevators, sidewalks, parking spaces, and driveways, and must comply with all markings and signs regulating traffic and parking. No furniture, boxes, packing materials, etc. may be left in any common areas.
- **Oversight.** All moving and delivery activities must be handled by the Owner or by your property manager or other on-site representative. It is recommended that owners utilize a professional moving company to assist with a move and that owners have an on-site property manager or owner representative to oversee all moving and delivery activities.
 - The HOA Manager, HOA staff, concierge, contractors, developer, etc. will not be available to assist with any portion of a move, including access, acceptance of deliveries, installation of common area protection, trash removal, clean-up, etc.
 - Owners must provide the HOA Manager with all relevant moving company information and the on-site owner contact no less than 48 hours in advance of the move.
 - Moving and delivery companies are responsible for providing any and all moving equipment. The HOA luggage carts may not be used for moving by anyone other than Owners and guests.
- **Protection.** Moving or delivery professionals must provide protective coverings for the elevator, stairway and pathways during the moving process.
- **Elevators.** Interior dimensions of the elevator cabs are approximately 5'6" deep x 6'4" wide x 8'6" tall. The door opening is about 3'6" wide x 7' tall. Oversized or overweight items may need to be moved utilizing the stairs.
- **Trash Removal.** All boxes and materials must be removed promptly. **Moving and delivery trash may not be disposed of in the property's trash room; all waste and recycling must be removed from the site by the moving and delivery companies.**
- **HOA Inspection.** The Owner or their on-site representative will be responsible for ensuring that the elevator, entrances, and other portions of the Project are clean and undamaged following all moves and deliveries. Owners will be responsible for damage caused by their guests, vendors, or subcontractors to any property owned or controlled by the HOA. Owners should review the moving company's protection procedures and insurance coverage. Within 48 hours following a scheduled move, the HOA Manager will conduct an inspection to determine if repairs or clean-up are required by the Owner as a result of a move or delivery, and any associated expense will be the responsibility of the Owner.

Address: 180 Wood Road



***** Second Moving
Truck Staging
Area*****

**ONLY Available after
January 1, 2025.**

**Wood
Road**

Moving
Truck
Staging
Area*****

Address: 180 Wood Road

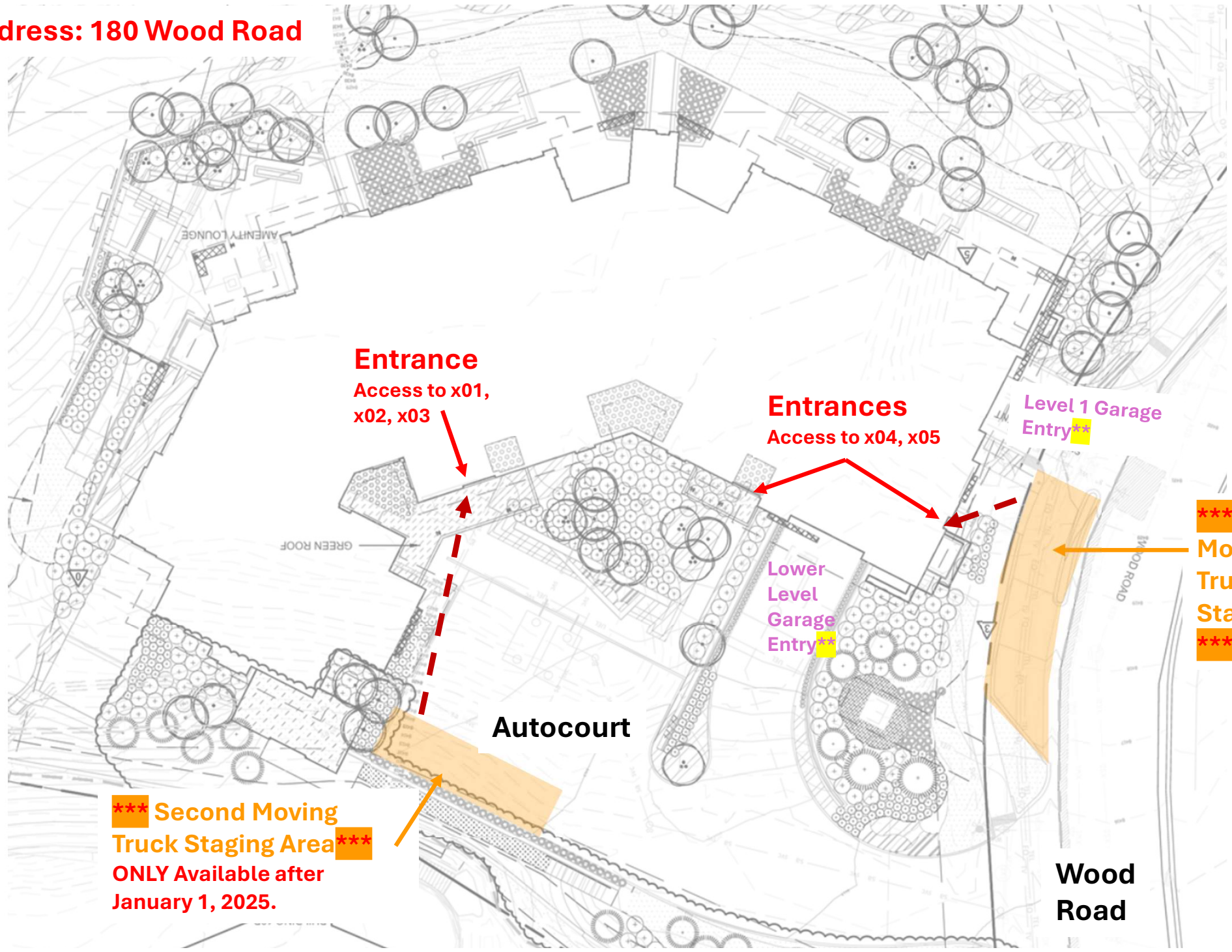

*** Second Moving Truck Staging Area***
ONLY Available after January 1, 2025.

*** Shared Emergency Access. No unattended vehicles. Driver must stay with the truck.
** Garages levels are for personal vehicles only; no moving truck access.

Address: 180 Wood Road

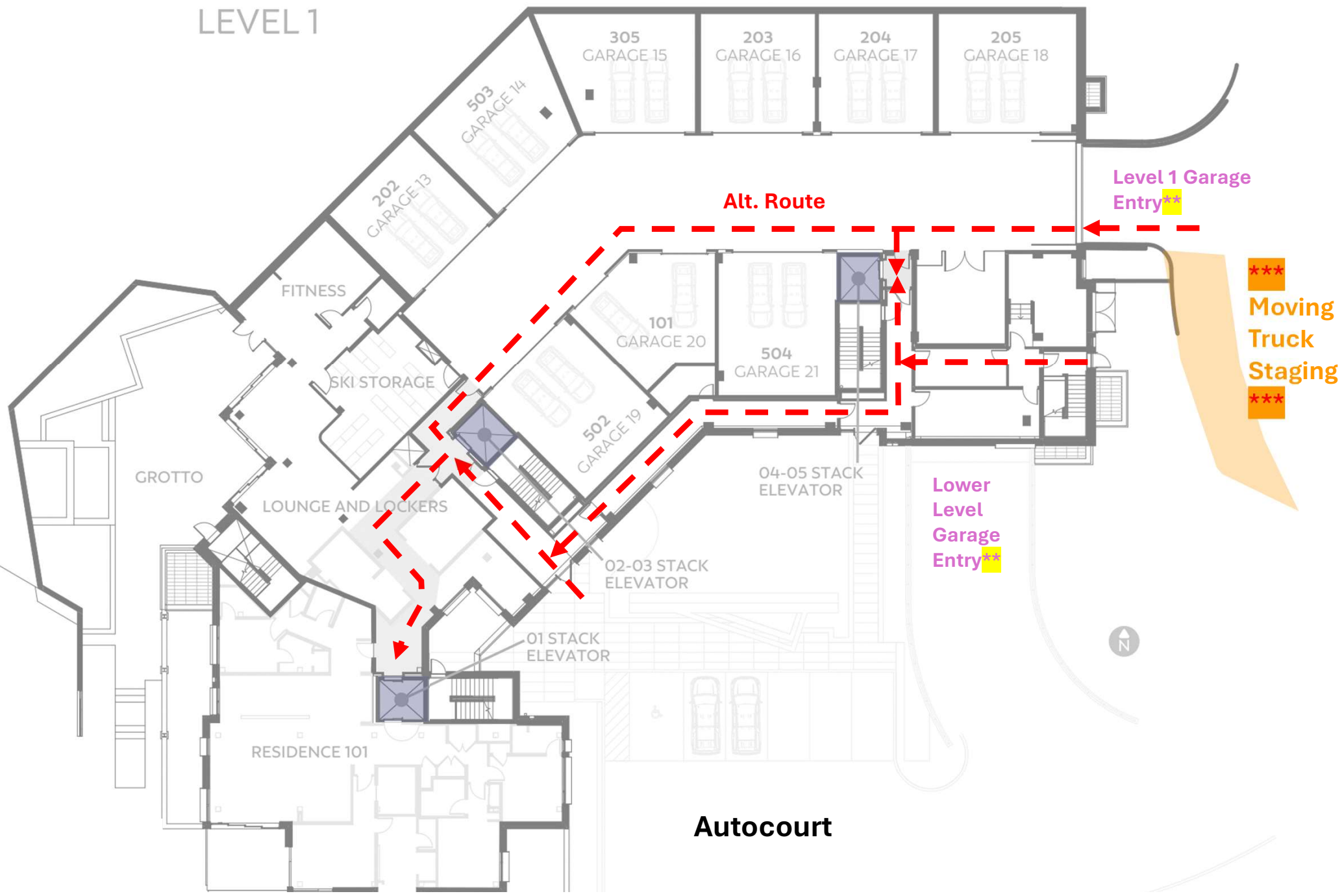

*** Shared Emergency Access. No unattended vehicles. Driver must stay with the truck.

** Garages levels are for personal vehicles only; no moving truck access.

LOWER LEVEL

